

SPACE AVAILABLE FOR LEASE



MARKET STREET BUSINESS PARK

10205 MARKET STREET

Market Street Business Park is an infill multi-tenant industrial park that provides easy access to major thoroughfares of I-610 (0.9 Miles) and I-10 (0.5 Miles) by way of Market Street and Mercury Drive.

PROPERTY HIGHLIGHTS:

Building Size: 14,435 SF
Doors: [4] Grade-level
Eave Height: 19' - 9"
Peak Height: 22' - 2"

Additional features include an enclosed, electrified gate with three access points, additional usable yard space, LED warehouse lighting, new roofing, improved fencing and an in-suite office upgrade.

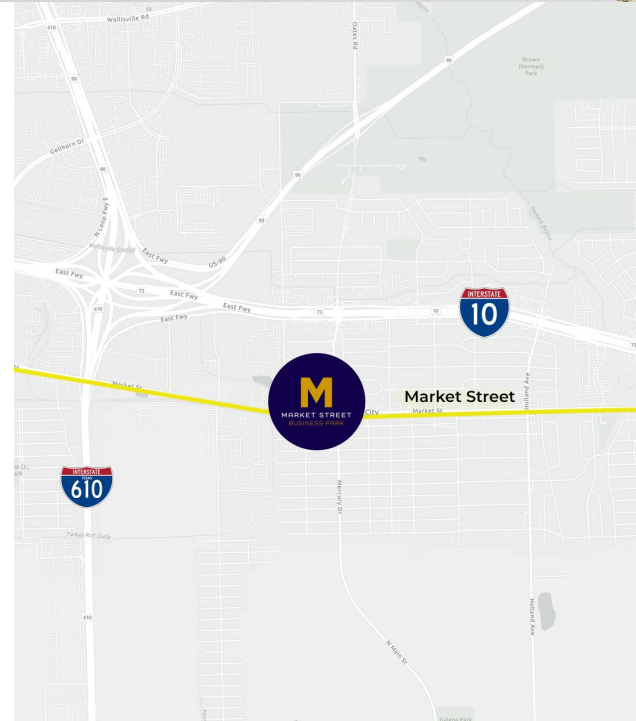

M MARKET STREET BUSINESS PARK

DIVISIBILITY OPTION

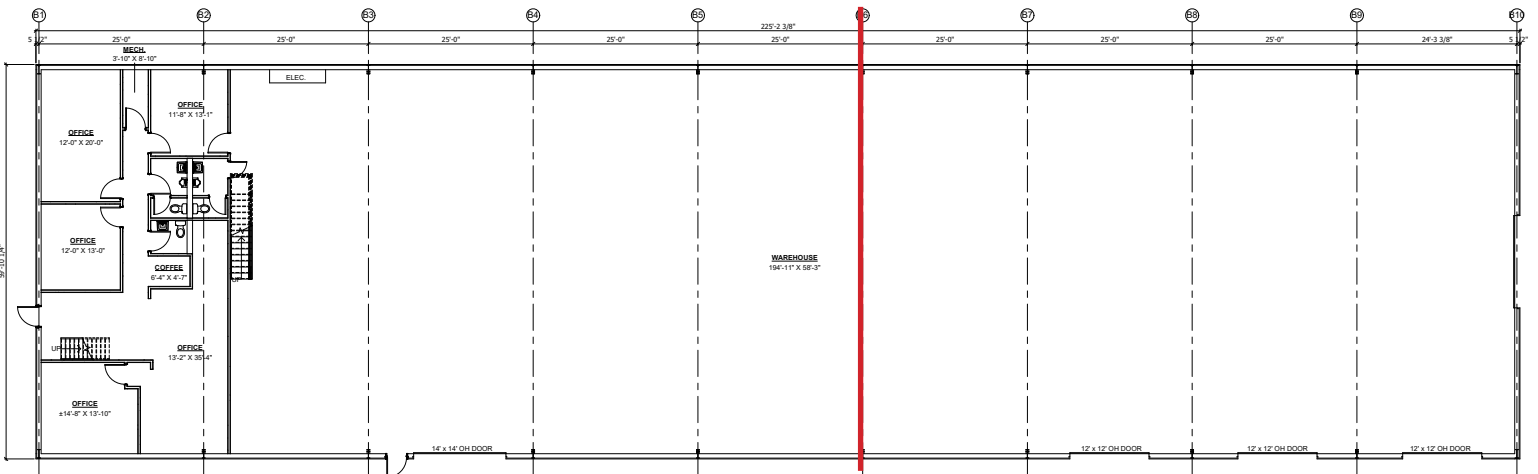

M MARKET STREET BUSINESS PARK



LEASED BY:



CONTACTS:

DERICK PERKINS
derickp@alpinecre.net
432-296-2994

KYLE FISCHER
kylef@alpinecre.net
281-627-0834

OWNED & MANAGED BY:
PAGEWOOD